

PRODUCT DATA SHEET

PE-X x PE-X L-connectors SDR 11

Full dimensional range of strong, reliable and easy to use PE-X x PE-X L-connectors from 25-125 mm in SDR 11.

Purpose-designed connectors with long fitting insert for superior grip on the PE-X pipe.

All brass wetted parts are in compliance with the European Drinking Water Directive. Clamping rings in dezincification-resistant (DZR) brass, preventing dezincification corrosion in aggressive conditions.

Easy to install bolt type connection without requirement for special tools or hydraulic equipment. Superior quality stainless steel pregreased bolts and nuts to avoid corrosion and cold-welding tendency.

O-ring free design, sealing on the PE-X pipe material for a durable leak tight connection.



- PE-X x PE-X L-connectors according to ISO 15875-3
- Pipes: PE-X/SDR 11, HDPE-100/SDR 11
- Pressure rating: PN 6 for heating, PN 16 for cold and cooling
- Material fitting insert: brass in accordance with European DWD 98/83/EC
- Material clamping ring: DZR brass
- Clamping bolt and nut: AISI 316
- O-ring free design

PE-X x PE-X L-connectors SDR 11

	Pipe size	D	L	Weight
Art. No.	d _{out} /s/d _{in} [mm]	[mm]	[mm]	[kg]
HLC25x25	25/2,3/20,4	50	60	0,3
HLC32x32	32/3,0/26,2	60	70	0,5
HLC40x40	40/3,7/32,6	80	85	0,9
HLC50x50	50/4,6/40,8	85	93	1,1
HLC63x63	63/5,8/51,4	105	115	1,9
HLC75x75	75/6,8/61,4	115	135	3,0
HLC90x90	90/8,2/73,6	140	155	4,7
HLC110x110	110/10,0/90,0	160	193	7,5
HLC125x125	125/11,4/102,2	185	209	9,8

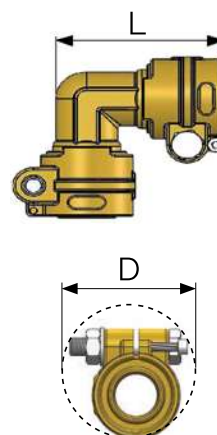

PE-X x PE-X x PE-X T-connectors

To branch off smaller supply lines from a main pipe, the use of T-connectors is required. These T-connectors are to be dimensioned and assembled as a function of the used pipe diameters.

Here is an example of a T-connector dimensioned to branch off a 32 mm heating supply line from a 63 mm main pipe.

The following types and quantities of components should be selected and assembled as shown in the drawing:

Art. No.		
HC63/2M	2 pcs.	63 mm heating terminal connector
HC32/1M	1 pc.	32 mm heating terminal connector
TP2	1 pc.	2" T-piece
RB2/1	1 pc.	Reducing bush (2" M x 1" F)

